

Technical Specifications

Voltage Range
100 – 240VAC 50/60Hz

IP Rating
IP66

Temperature Range
-20 to +50°C

IK Rating
IK09

Mounting Plate

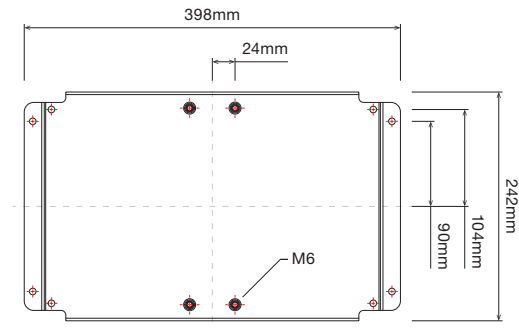

INSTALLATION INSTRUCTIONS

Step 1

Choose luminaire position and orientation.

When choosing the location of Tunnel Ray luminaire, please ensure that sufficient clearance is allowed for the airflow through the heatsink. Avoid blocking the air vents.

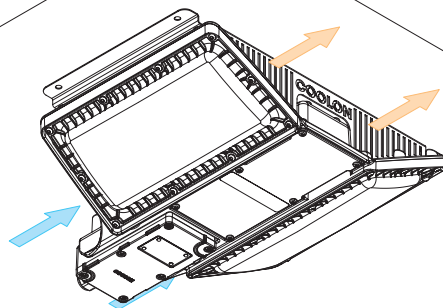

Horizontal Mounting

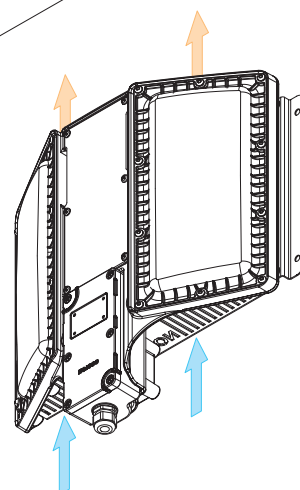

Vertical Mounting

In a vertical mount, mount the TNR in the following orientation to maximize the airflow through the heatsink.

INSTALLATION INSTRUCTIONS (Continued)

Step 2

Once the Tunnel Ray is securely mounted, open the junction box. Ensure to only open an accessible area of the junction box that is sealed with Phillips Head screws.

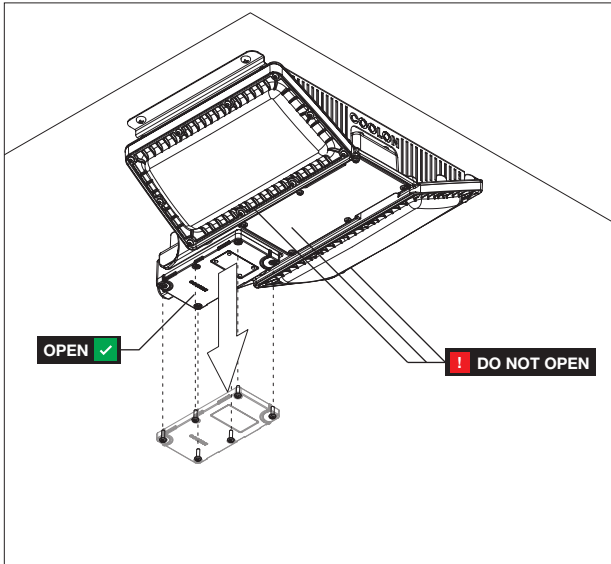

Step 3

Feed the cable through the cable gland. Connect wires to terminals according to the wiring diagram below and secure the cable with the cable restrainer.

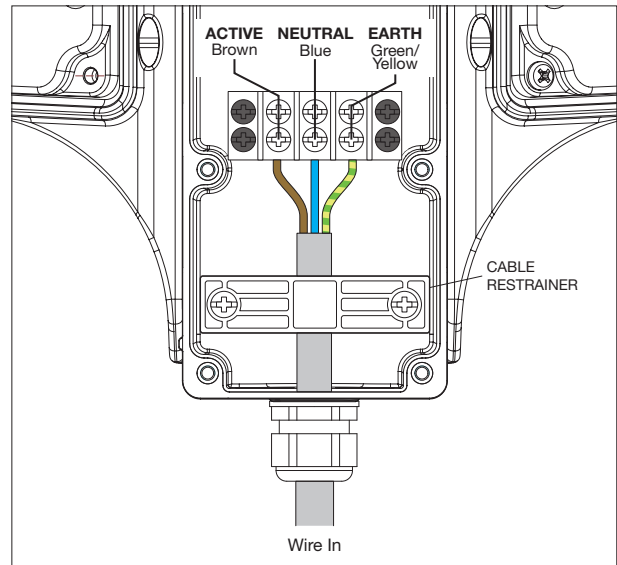

Step 4

Close the junction box. Ensure the rubber gasket is intact and sits snugly in the dedicated channel. Secure junction box cover back onto the Tunnel Ray luminaire using the Phillips Head screws.

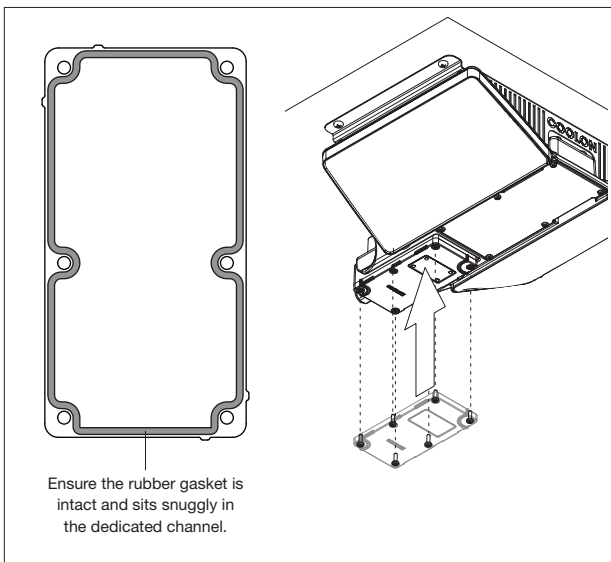

External Earthing

When mounted on a non-conductive or non-earthed facilities, the body of the luminaire needs to be externally grounded.

One of the 4, M6 nutserts can be used as appropriate. It is recommended that a spring/locking washer and 4mm² cable with a suitable terminal is used (not supplied with the fitting).

