



PLUME 10 DC INSTALLATION INSTRUCTIONS



▪ PROFILE DIMENSIONS

With Ball Joint Mounting Bracket

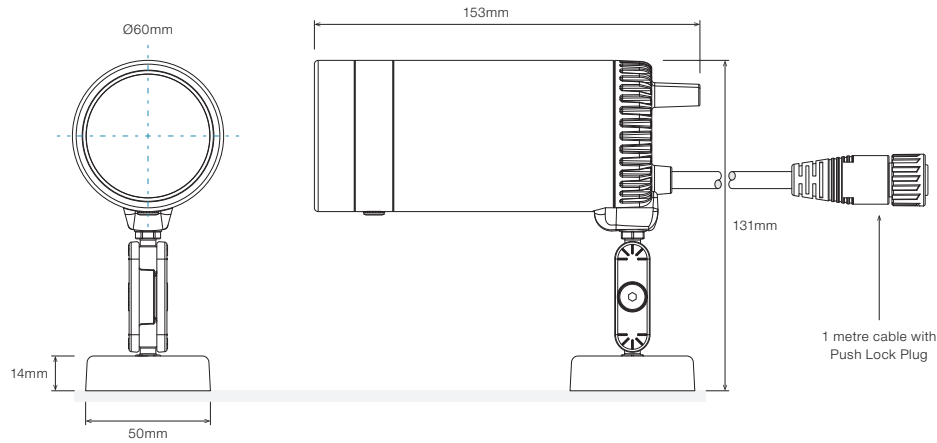

⚠ ATTENTION

- Please observe / follow the instructions methodically.
- Please ensure the units are handled with extreme care.
- Do not remove product from packaging prematurely. Only remove from packaging when ready for installation.
- Failure to observe installation instructions and handling will void warranty of the product.
- Fittings must be installed by a licensed electrician.
- Before installing, make sure the power supply is switched off or mains cable is disconnected.

Ball Joint Mounting Bracket Rotation

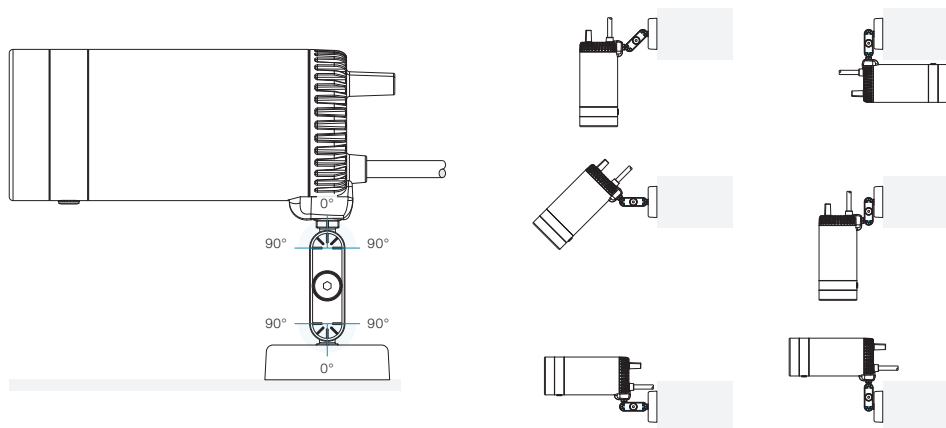

▪ PACKAGING DIMENSIONS

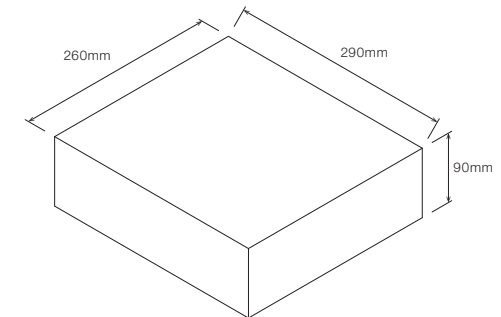

PACKAGED WEIGHT

1.1kg (contents can vary)

▪ WIRING DIAGRAMS (POWER)

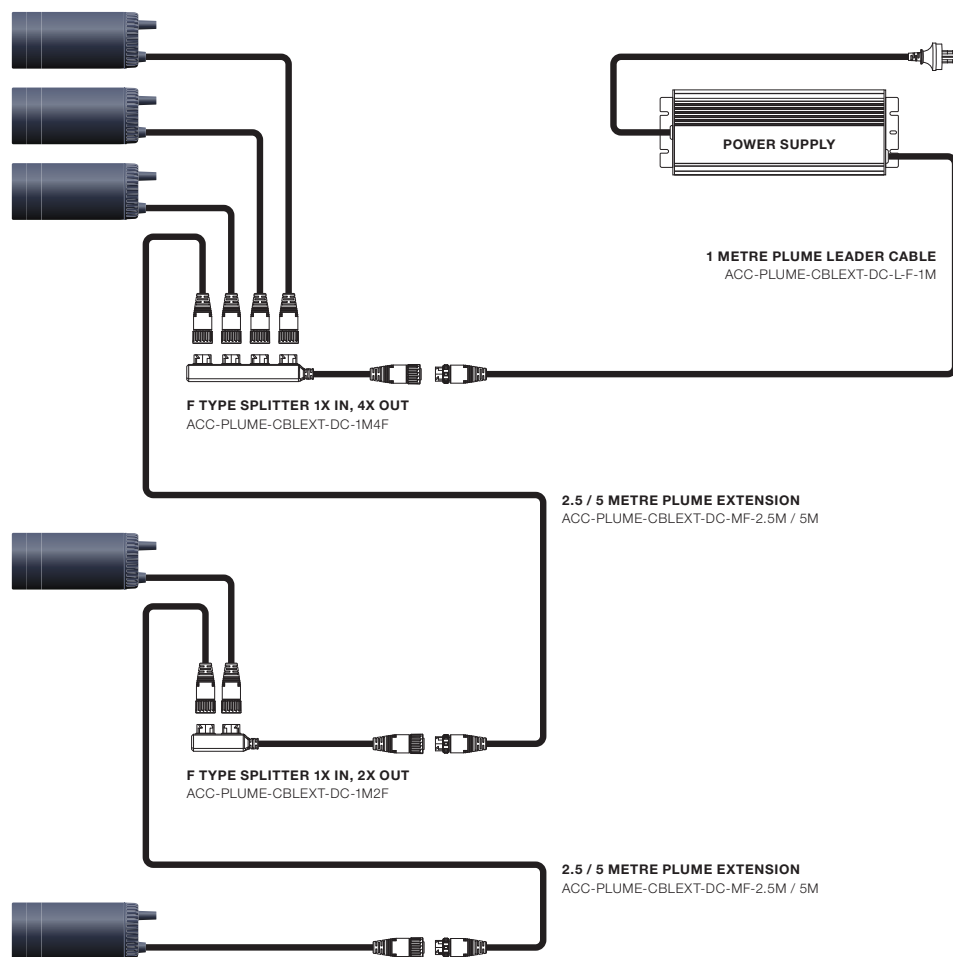

Splitters and extensions can be used as required within the following limits:

DC wiring from power supply to last unit: Up to 20 metres @48V / Up to 5 metres @24V.

Max. # of units per run: Up to 35 Units @ 48V / Up to 30 Units @ 42V / Up to 25 Units @ 30V / Up to 10 Units @ 24V.

Uncoil all cables. 10A max through current.

Consult Coolon for special wiring requirements.



WIRING DIAGRAMS (CONTROL)

CASAMBI INSTALLATION

Plume not recommended for Classic Casambi Networks



NEW DALI INSTALLATION

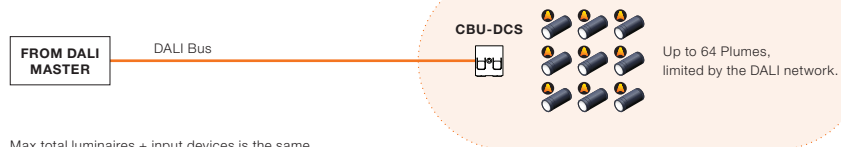

Max total luminaires + input devices is the same for one DALI network (CBU-DCS not included)



EXPAND EXISTING DALI INSTALLATION

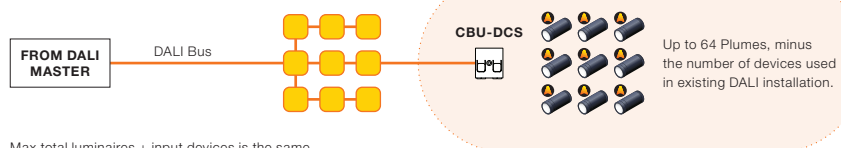

Max total luminaires + input devices is the same for one DALI network (CBU-DCS not included)



DMX INSTALLATION

DMX as casambi scene trigger

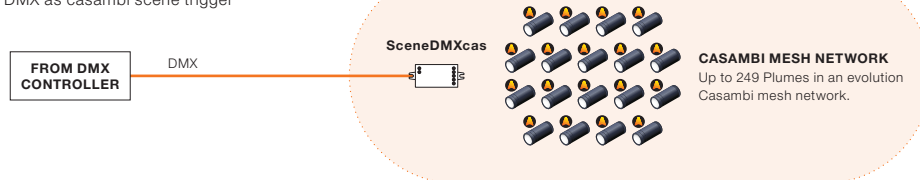

SceneDMXcas provides scene and intensity selection for up to 20 pre-defined Casambi scenes.

The DMX Start Address for each SceneDMXcas is user selectable.

SceneDMXcas can be configured with the Casambi app.

SceneDMXcas requires an external 12 – 24VDC Class 2 power supply.

Please refer to SceneDMXcas documentation for detailed instructions.

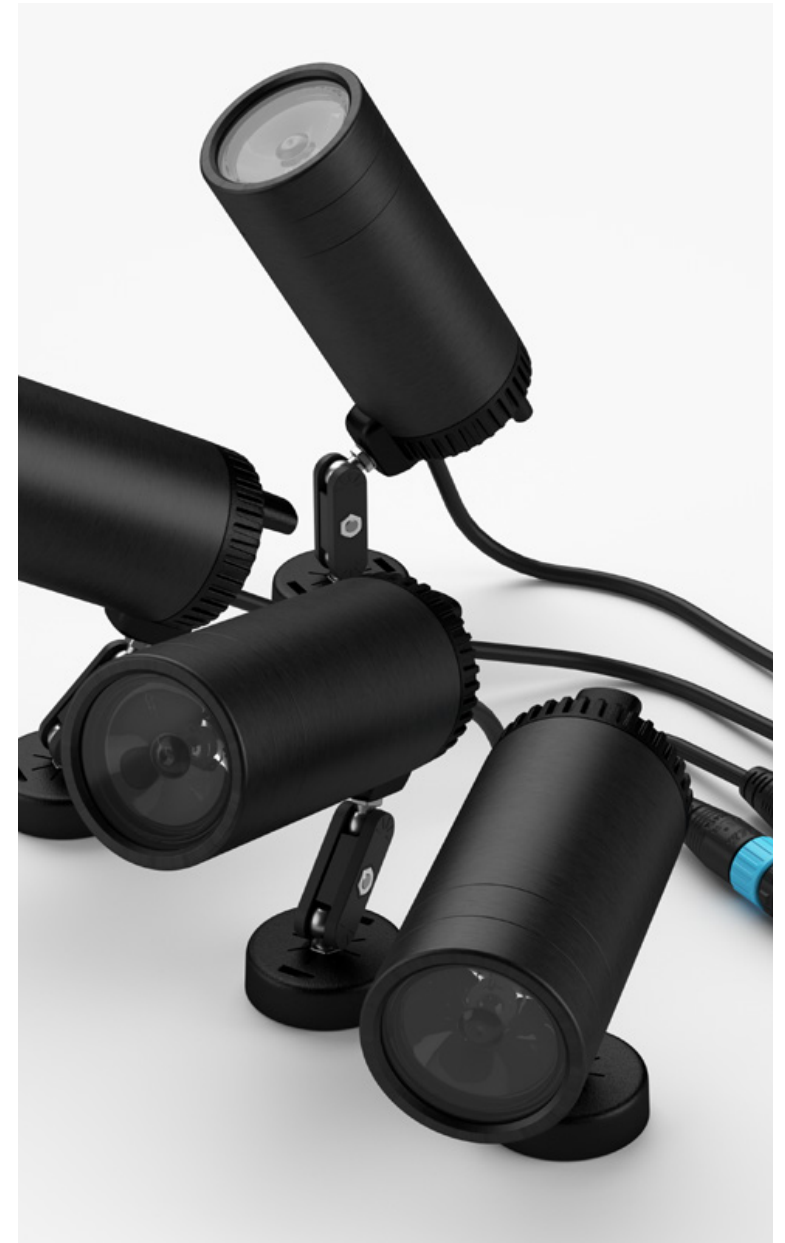



SPOT VISOR ACCESSORY (Sold Separately)

▪ STEP 1

Align spot visor with Plume Spotlight.

Spot visor can be mounted at 0° or 90°.

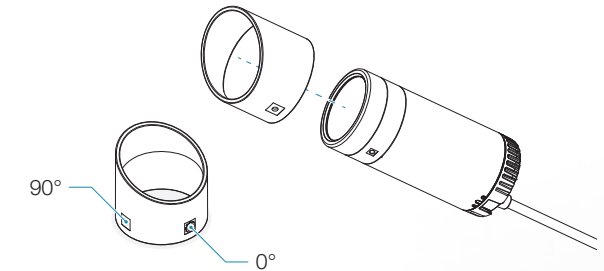

▪ STEP 2

Slide spot visor over spotlight body until the end stop is in contact.

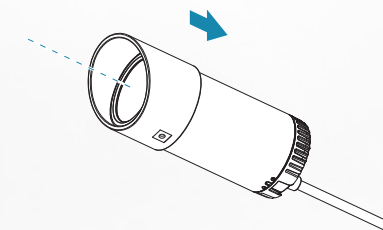

▪ STEP 3

Insert screw with star washer and tighten with hex key (1.5Nm).

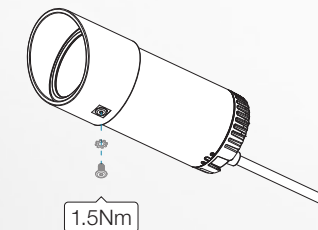

BALL JOINT MOUNTING BRACKET

STEP 1

Pick up base plate and select 2 suitable screws, refer to the table below for details.

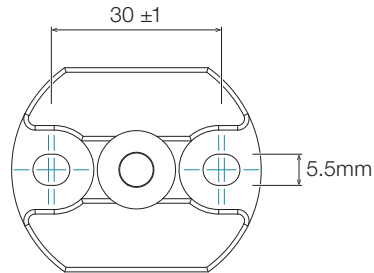

SCREW TYPE	THREAD SIZE
Metric Machine Screw	M5
Self Tapping Screw	10g (4.8mm)

SCREW HEAD WASHER Ø (MAX)	SCREW HEAD WASHER HEIGHT (MAX)
Ø13.5mm	6.5mm

LENGTH

Dependant on installation conditions. Requirement: centre of ball head must withstand a vertical load of 20N and torque of 2.5Nm

Locate and install base plate on wall/surface. Ensure screws are fully secured.

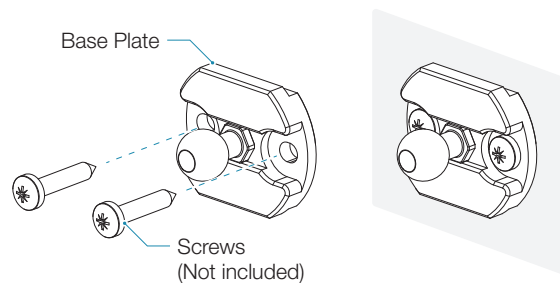

STEP 2

Pick up base cover and align with base plate. Slot must be parallel to base plate edge.

Snap base cover onto base plate as shown.

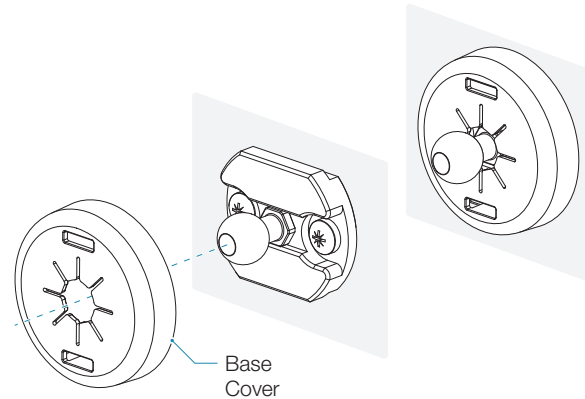

STEP 3

Loosen adjustment screw until bracket arms fit over the ball head stud.

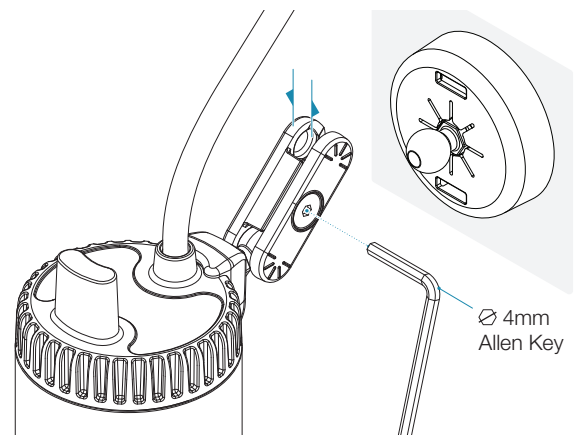

STEP 4

Move / rotate spotlight to desired position, hold tight and fasten adjustment screw (recommended torque 10Nm)

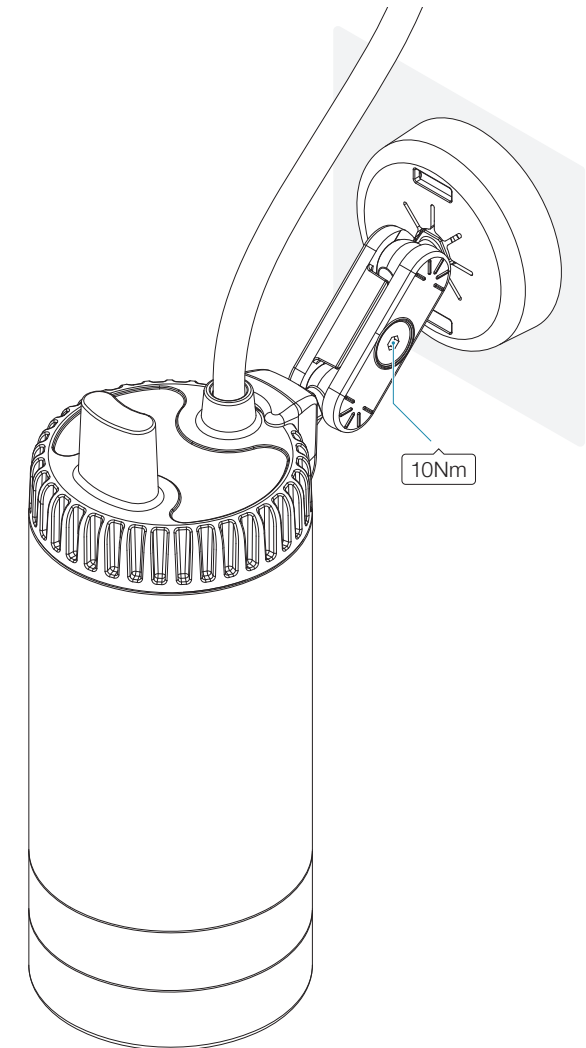

SPIKE MOUNTING

STEP 1

Install Spike Accessory to luminaire.

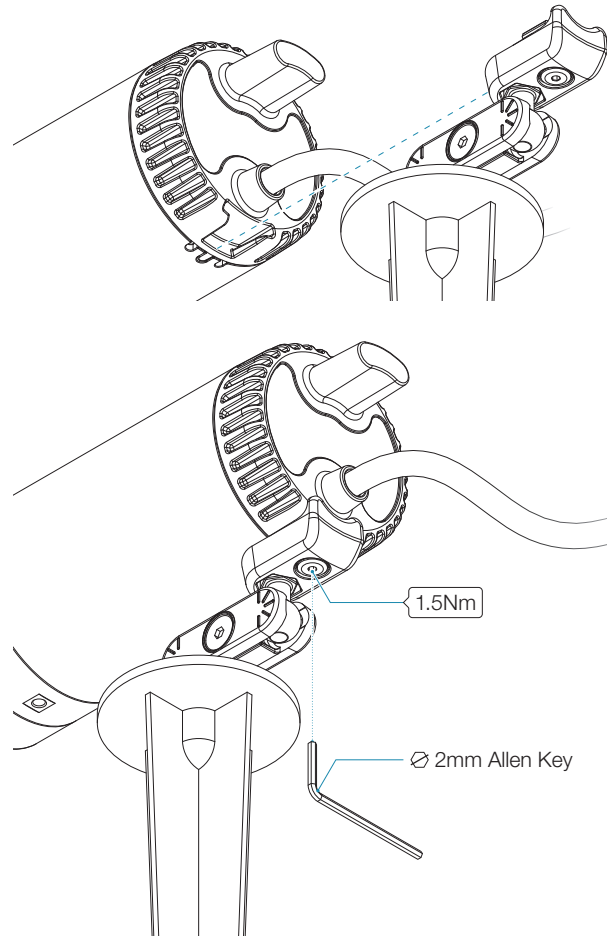

STEP 2

Insert assembly into the ground.

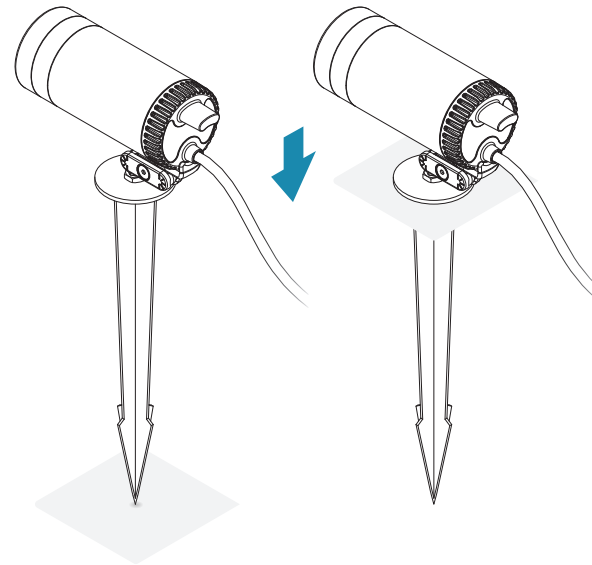

STEP 3

Aim the spotlight to desired position, hold tight and fasten adjustment screw (recommended torque 10Nm)

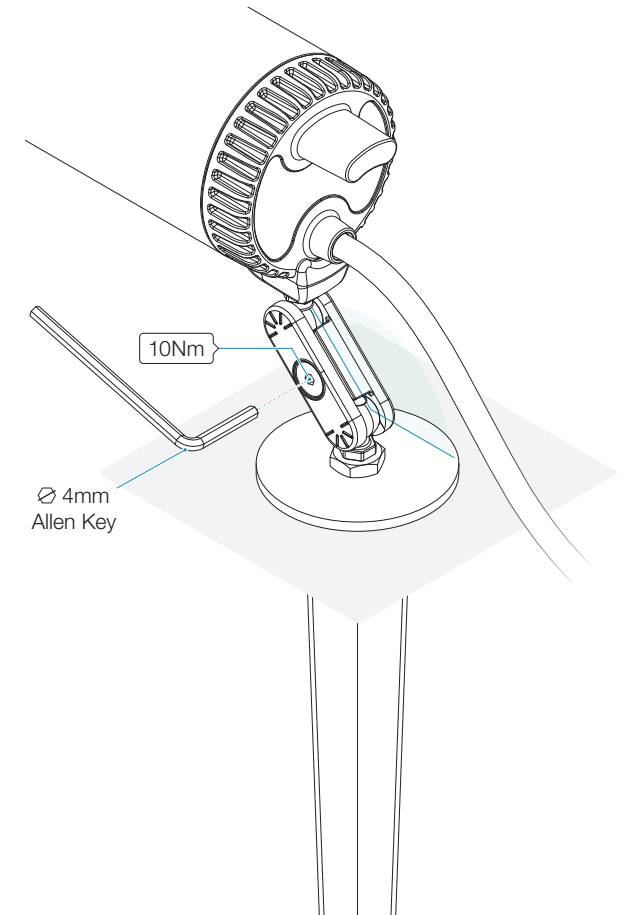

CASAMBI READY



Casambi is designed specifically for lighting and allows the user to easily control / automate a space using their phone, tablet or wireless switch.

For more information, please visit <https://casambi.com/>

For a range of switches please visit <https://casambi.com/ecosystem/> and explore the options.

For use with a tablet and smart phone, download the Casambi app and follow the easy to use instructions to pair with your luminaire.



How to use Casambi for the first time
<https://youtu.be/H5DRQ2vCQDw>

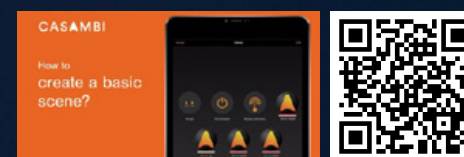

How to create a basic scene
https://youtu.be/RGXkXU_4r2A

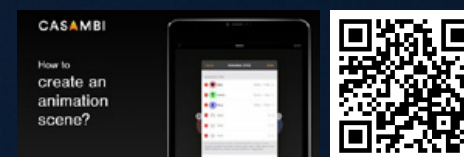

How to create an animation scene
<https://youtu.be/0RJ3Hvwwtpto>