

CASSIDY

LED FLOODLIGHT

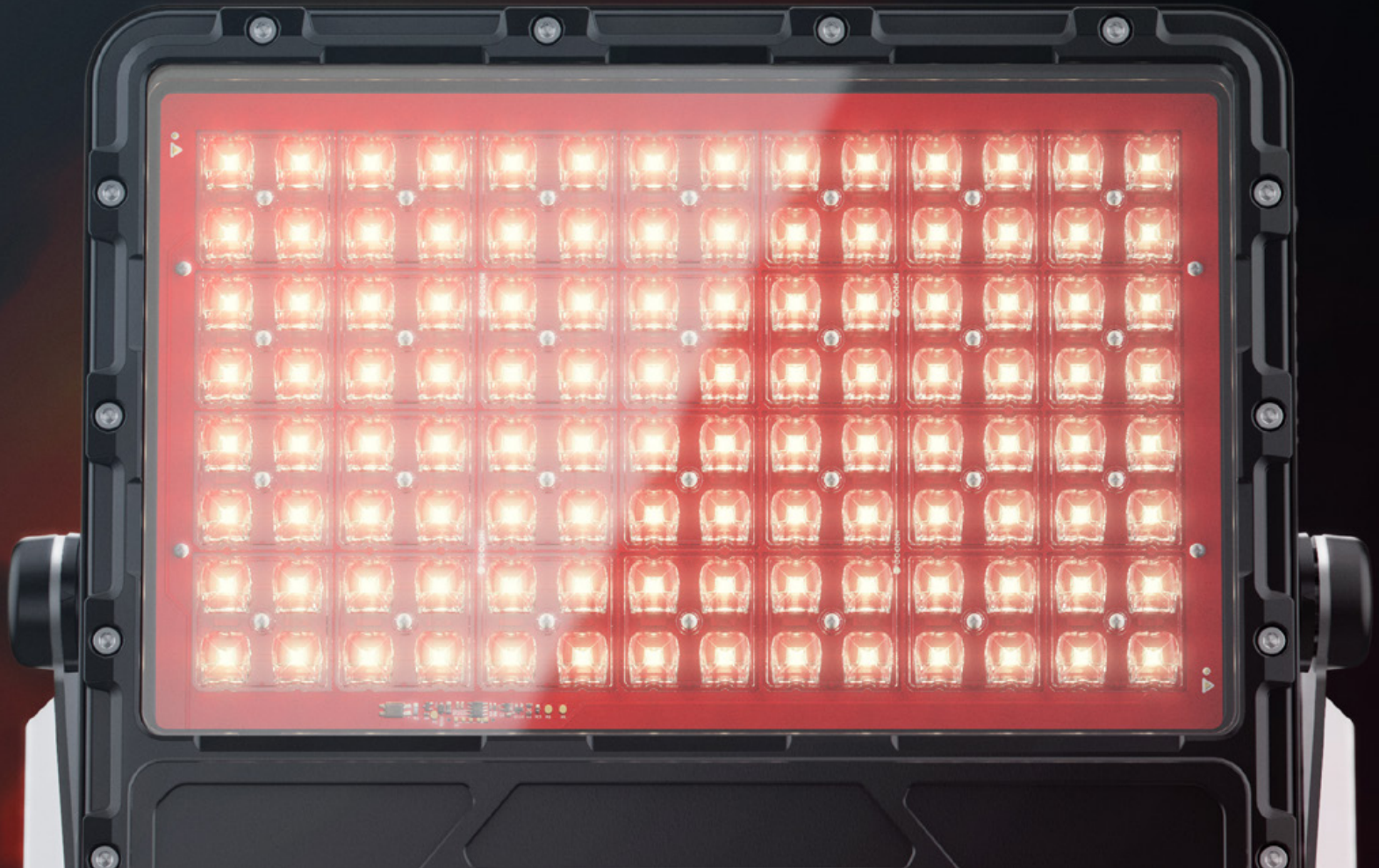

Good. Better. *The Best.*

Sometimes you need a luminaire to work in extremely harsh environments. Get covered in dirt and still provide the widest light coverage. Withstand extreme heat and operate efficiently.

Sometimes you need *Cassidy*.





Built to survive

Invincible to highly contaminated environments. Invulnerable to dirt, dust or mud. Indestructible in heat beyond naturally possible extremes.

Unrivalled perimeter coverage with top quality intense light. Introducing the all-new Cassidy.

Engineered with the harsh conditions of an industrial site in mind, Cassidy is complete with a corrosion-proof LM6 alloy body, SS316 mounting bracket and a Low Iron tempered Glass diffuser in combination with superb LED Driver and top of the range LEDs. Result? Unprecedented long life, countless mounting options and a wide perimeter coverage.



Get dirty

Dirty shouldn't mean damaged.

Cassidy is prepared for real industrial environments. Its robust glass prevents the dirt from burning in and damaging your luminaire. Multi-layer coating resists corrosion by toxic chemicals. The light is sealed to avoid dust and water penetration, keeping the performance predictably consistent.

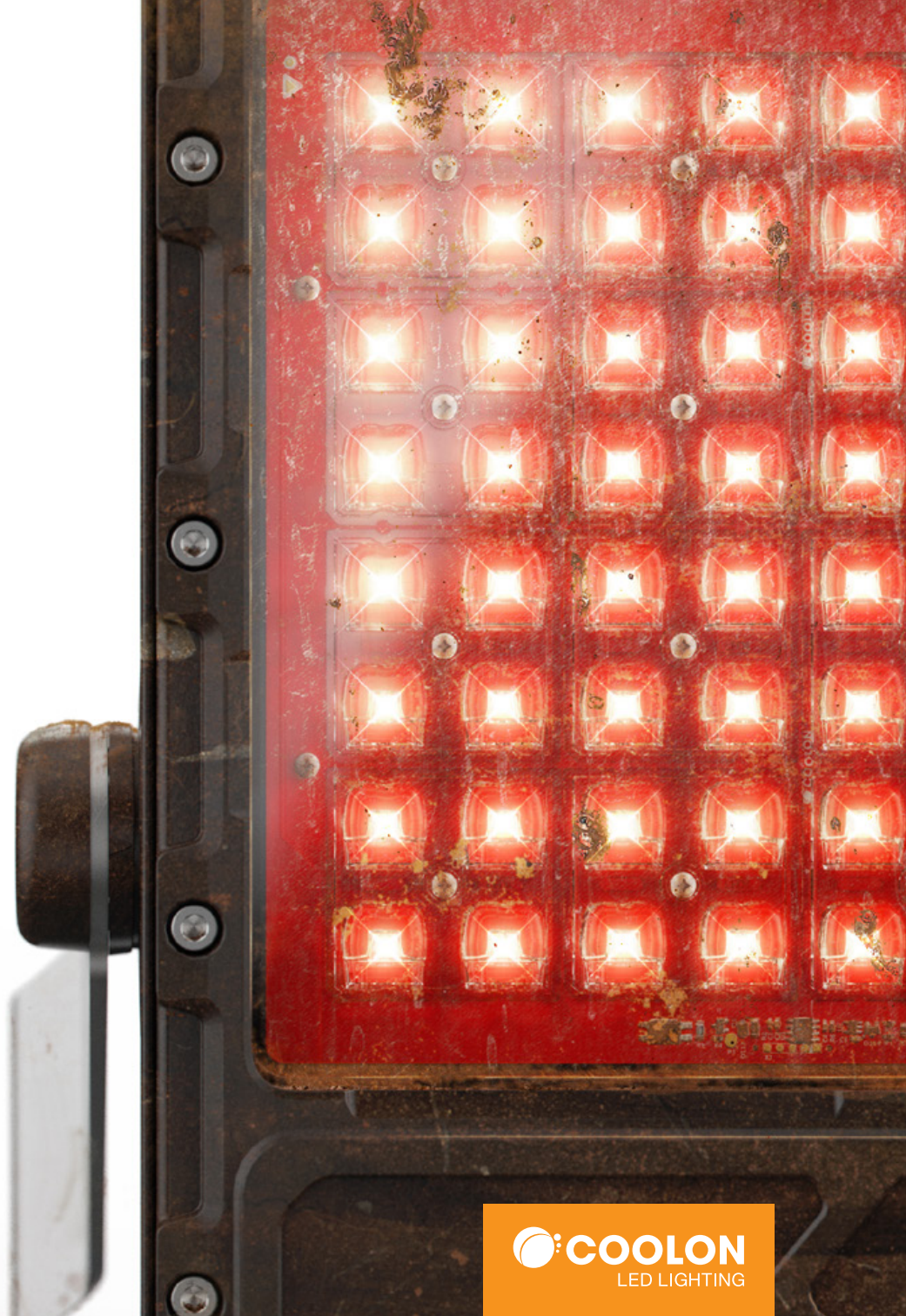



Some like it hot

Overheating LEDs are a big problem. But with Cassidy, it's not your problem.

We can't control where Cassidy is installed. But that's not a problem because Cassidy can control itself. Equipped with active thermal management to preserve itself from any damage, Cassidy performs brilliantly in hot conditions and is perfect for a high-temperature industrial environment.

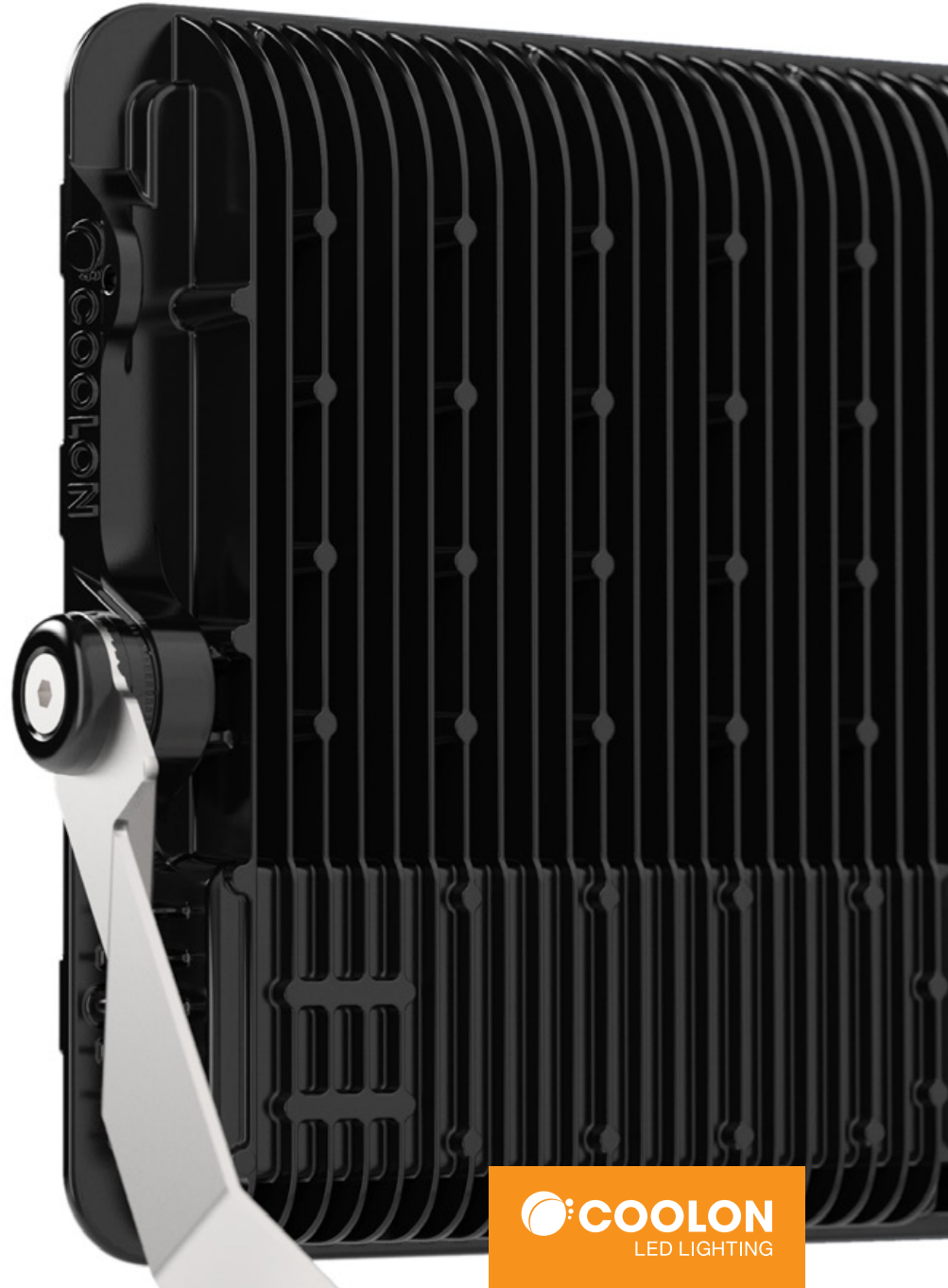



Wide coverage

More perimeter coverage and better light quality with less luminaries.

A larger area doesn't have to mean more lights. Cassidy's powerful LEDs coupled with a broad range of optics provide wider surface coverage without losing intensity or quality of light.

Less investment, less equipment, less labour, less maintenance.





i Wide range of optics gives full control over light settings and makes Cassidy suitable for different applications varying from workshop to high mast.



ii LM6 alloy body completed with stainless steel hardware and coated with multiple protective layers – all to ensure resistance to corrosion, harsh chemicals and tough environments.



iii The compact junction box is safely concealed with a fall-proof cover and stainless-steel screws. None of the components will fall out when opened, minimising installation and maintenance time.



iv The breather valve is seamlessly hidden inside the body to avoid any physical damage and prevent blockages.



v Precision folds in Cassidy's bracket prevent damage from vibration, which is one of the most common reasons for fixture failure.

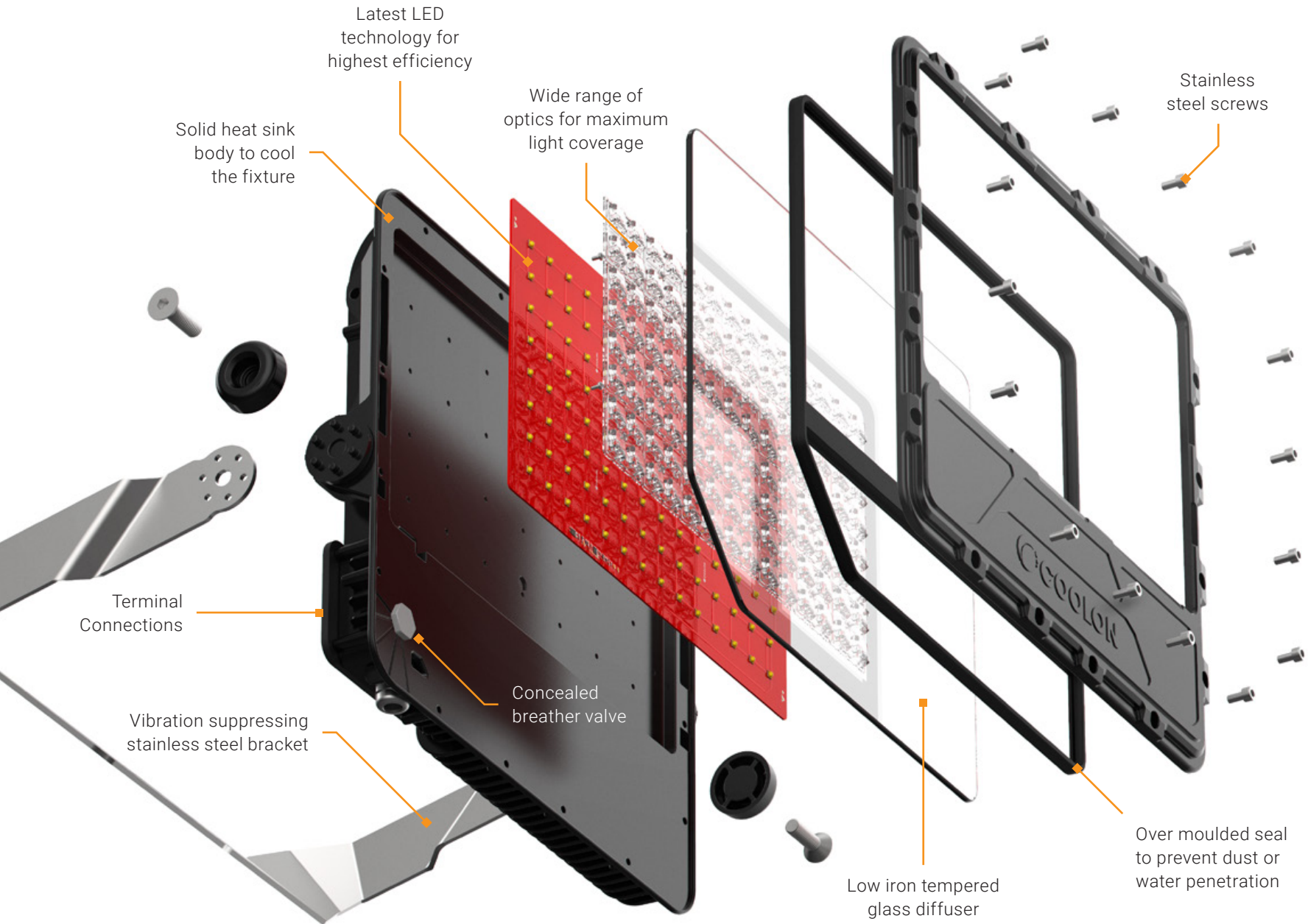

Latest LED technology for highest efficiency

Solid heat sink body to cool the fixture

Wide range of optics for maximum light coverage

Stainless steel screws

Terminal Connections

Vibration suppressing stainless steel bracket

Concealed breather valve

Low iron tempered glass diffuser

Over moulded seal to prevent dust or water penetration





Now that you and Cassidy are closely acquainted, it's time to meet the whole family of our game-changing lights. From industrial conveyor lights, high bays and SuperBeams, the unparalleled performance and indestructibility run in the blood. Or flow in the wires, should we say.

Meet the Coolon family and find your perfect lighting solution.

WEBSITE

www.coolon.com.au

EMAIL

support@coolon.com.au

PHONE

1300 287 533
+613 8681 3633

FOLLOW US



Search: Coolon LED Lighting

