

CP66 Luminaire

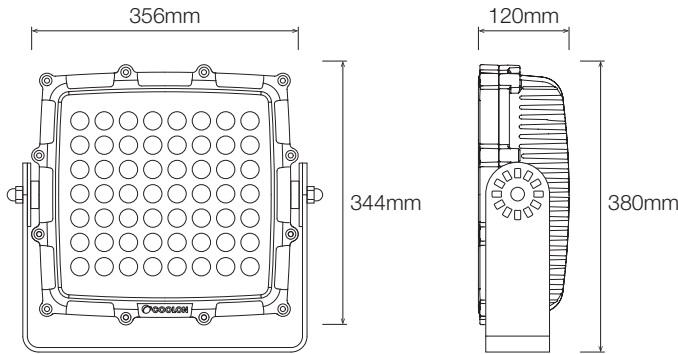

Power Supply (PWR-CLN-320-48-0281AL)

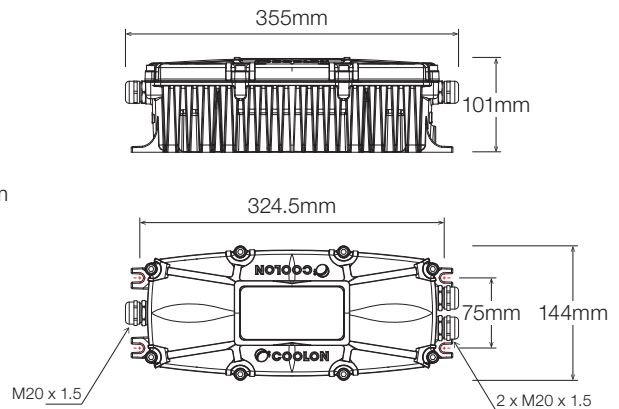

Technical Specifications

Voltage In (Luminaire)

45 – 48VDC

Voltage In (Power Supply)

100 – 277VAC

Power

320W

IP/IK Rating

IP66 / IK09

Operating Temperature

-20°C ≤ T_{amb} ≤ 50°C

**Fixed Plant Bracket
SPR-CP56-MBR-FPB**

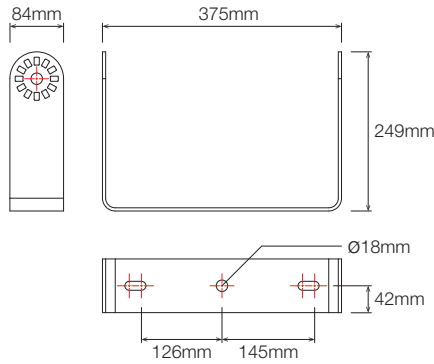

**Mobile Plant Bracket (Optional)
SPR-CP56-MBR-FPB**

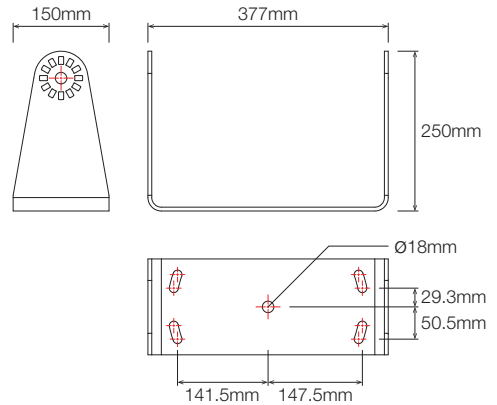

WIRING

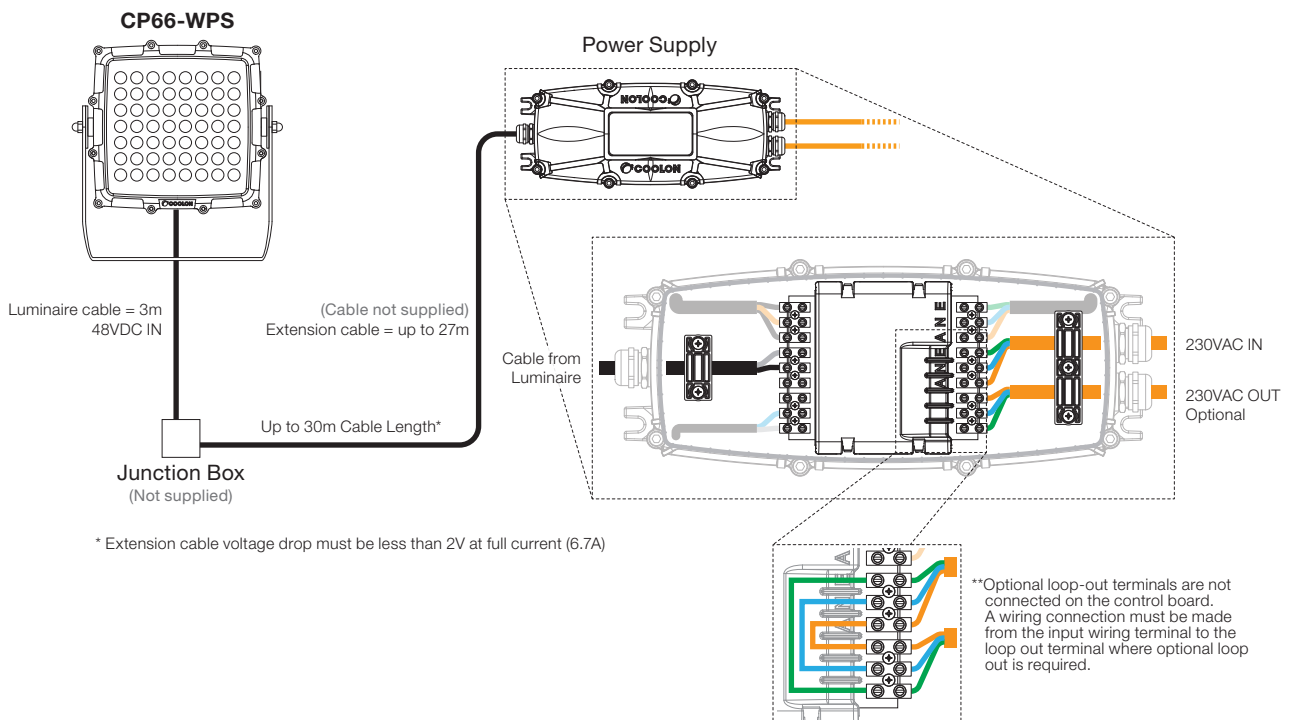

MOUNTING BRACKET INSTALLATION

Step 1

Install arm locks onto protruding studs on both sides of the housing as shown below.

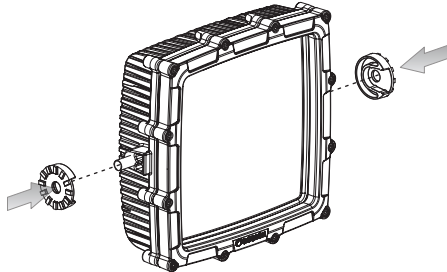

Step 2

Apply necessary force to open the bracket in order to fit over the properly positioned arm locks.

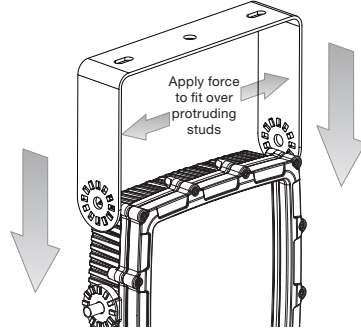

Step 3

Align perforated slots in mounting bracket against corresponding notches in the arm locks, then tighten the nut. Ensure that all the perforated slots sit firmly on the notches after tightening up the nuts. Recommended tightening torque is 40Nm.

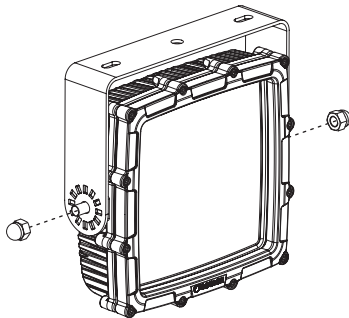

Please use Loctite® 243™ retaining compound (not included) to secure the dome nut.

IMPORTANT: Ensure that all perforated slots sit firmly on the notches after tightening up the dome nuts.

